

# Hearthside

PREMIER RETIREMENT LIVING



**CROSS KEYS VILLAGE**  
The Brethren Home Community



# Hearthside

PREMIER RETIREMENT LIVING



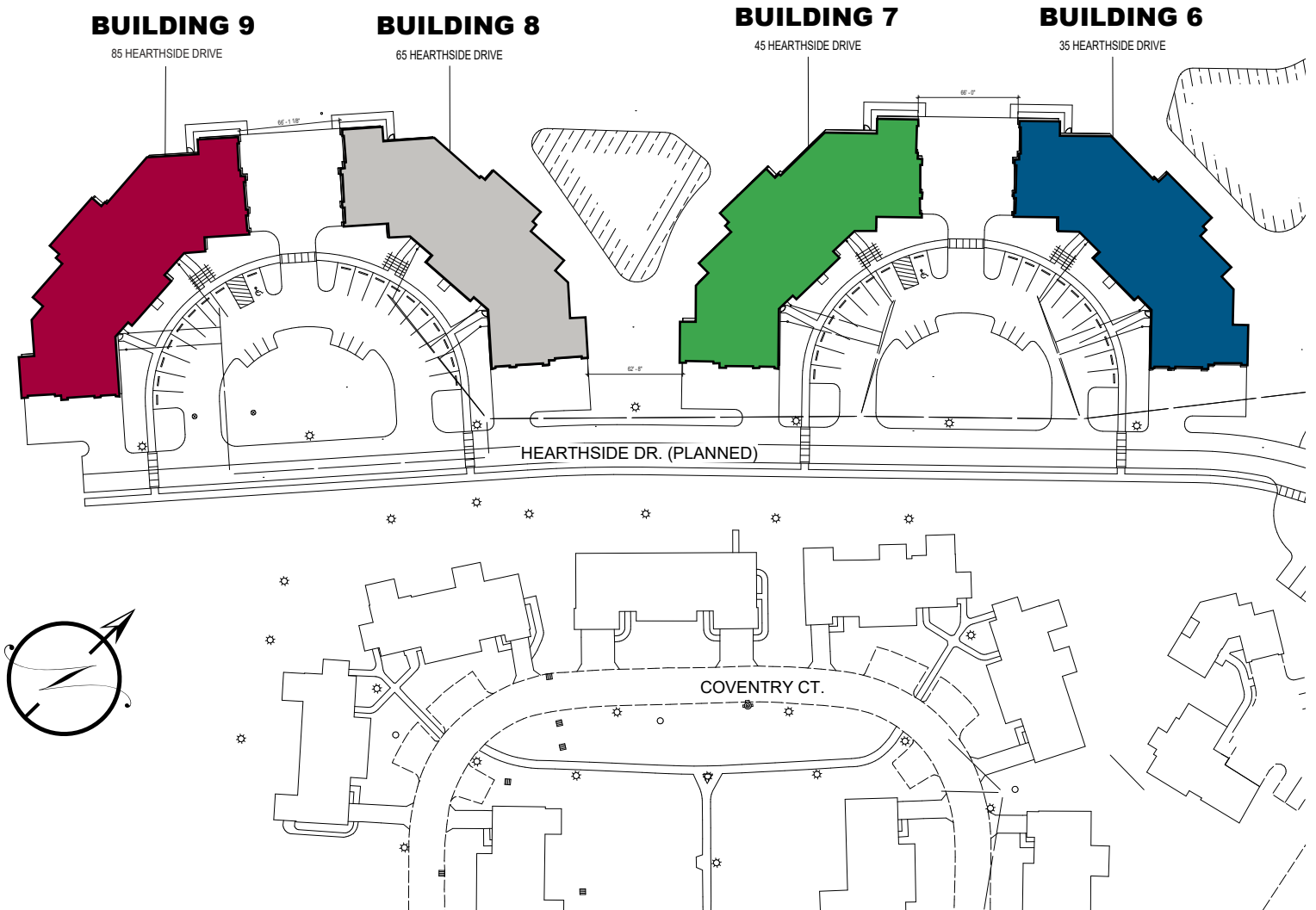



# Picture Yourself at Cross Keys Village

## Services Included:

- Priority access to higher levels of care
- Social, cultural, recreational, and fitness programs
- Electricity and gas heat
- Cable television
- Local scheduled transportation
- Interior and exterior maintenance and repairs
- Groundskeeping/snow removal
- Trash and recycling
- Property taxes
- Water & sewer
- 24-hour emergency/security system
- Secure storage
- One garage space

## Ala Carte Services:

- Internet
- Phone service
- Dining plan options in various venues
- Housekeeping
- Personal transportation



# Brierley



- 1 Bedroom
- 1 1/2 Baths
- Walk-in Closet
- Laundry Room
- Den
- 1,260 sqft

# Ambleside



- 2 Bedrooms
- 2 Baths
- Walk-in Closets
- Laundry Room
- 1,390 sqft

# Idlewild



- 2 Bedrooms
- 2 Baths
- Walk-in Closets
- 1,425 sqft



- 2 Bedrooms
- 2 Baths
- Walk-in Closets
- Laundry Room
- 1,470 sqft

# Heathfield



- 2 Bedrooms
- 2 Baths
- Walk-in Closets
- 1,680 sqft

# Heathfield Deluxe



- 2 Bedrooms
- 2 Baths
- Walk-in Closets
- 1,740 sqft

# Hearthside Level Floor Plans

## Buildings 6 & 8

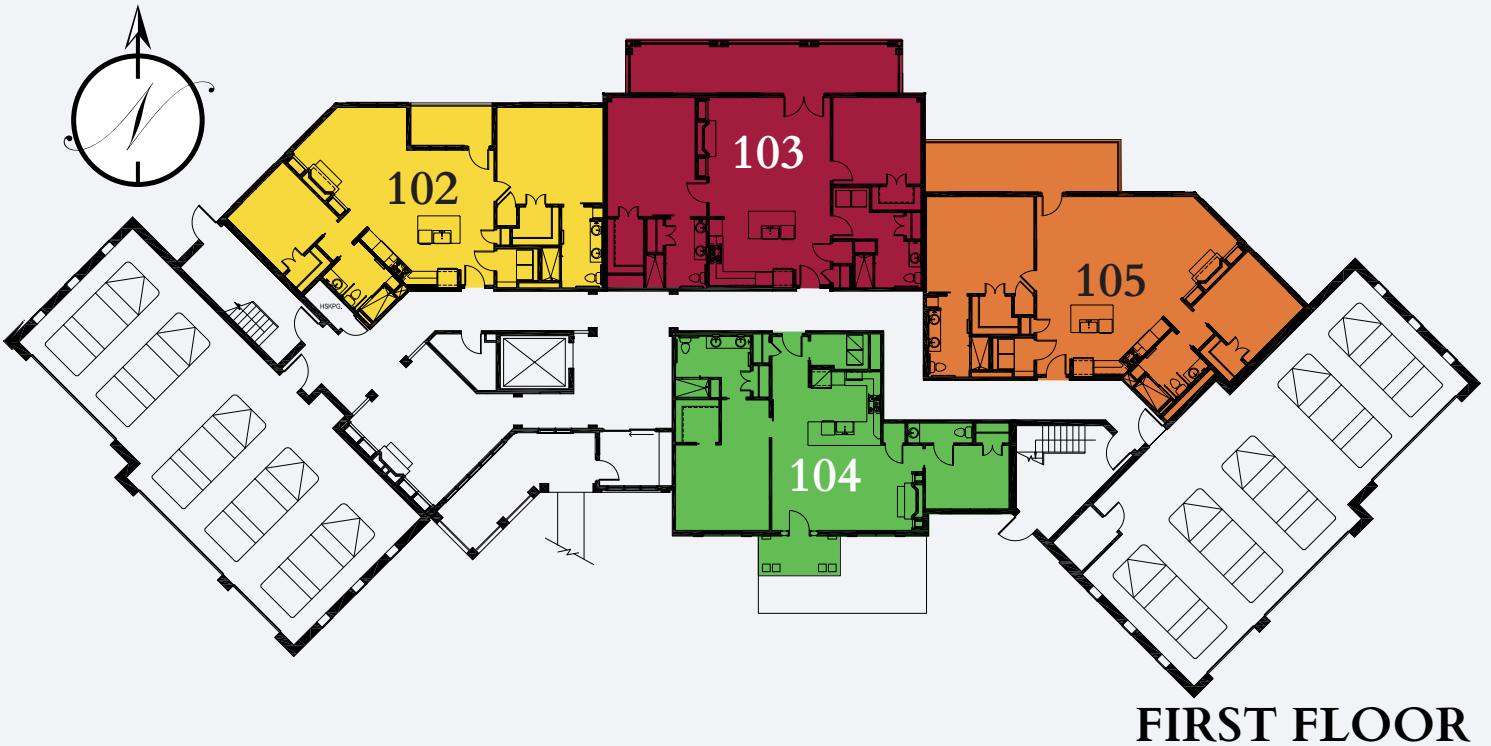
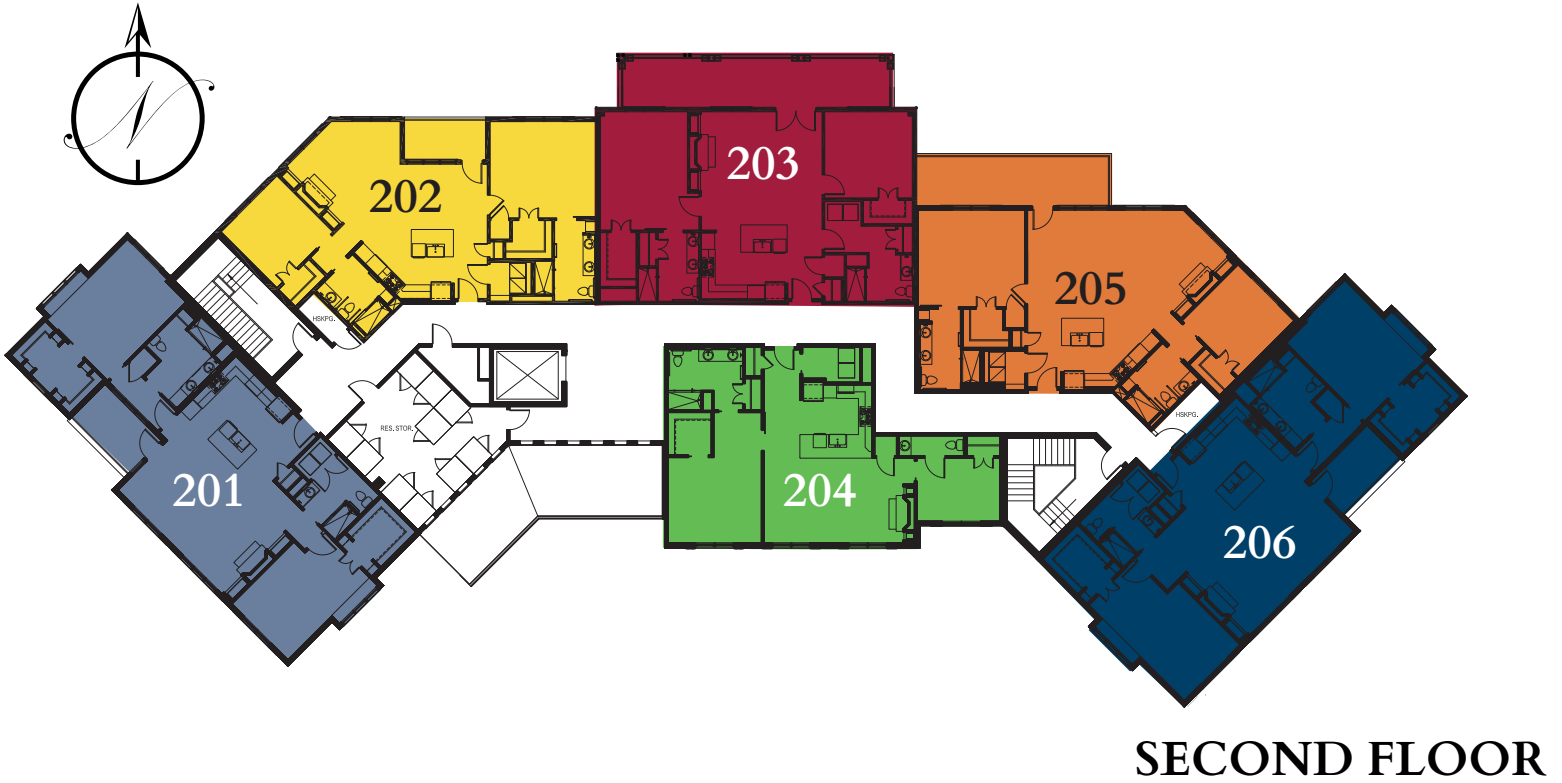

-  BRIERLEY
-  AMBLESIDE
-  IDLEWILD
-  HUNTLY
-  HEATHFIELD
-  HEATHFIELD DELUXE

## Buildings 7 & 9



**SECOND FLOOR**



**FIRST FLOOR**



# Hearthside

PREMIER RETIREMENT LIVING



# Where Tradition Meets Enhanced Living

Our Hearthside homes draw inspiration from the classic Gettysburg farmhouse style, creating a warm, inviting atmosphere that instantly feels familiar. Intimate, neighborly homes with only ten spacious apartments per building encourage genuine connections, while thoughtfully furnished common spaces invite spontaneous gatherings, book clubs, card parties and social hours. Our “traditional with a twist” community design means you’ll enjoy timeless style paired with a lively, modern approach to senior living — where every detail is crafted to help you feel at home.



## Projected Timeline

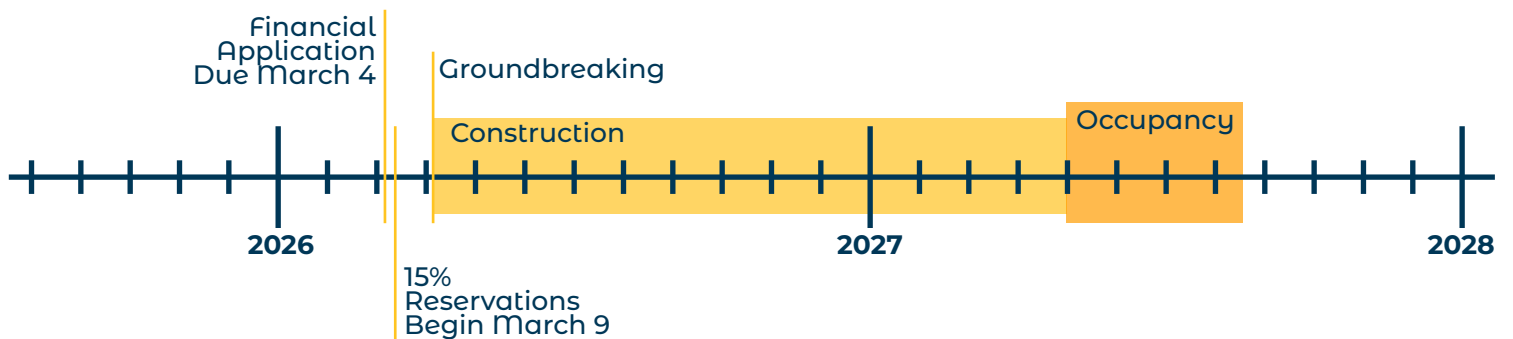



## CONTACT US TODAY!

### **Amy Beste**

Retirement Counselor

717-624-5232

[a.beste@crosskeysvillage.org](mailto:a.beste@crosskeysvillage.org)

### **Nancy Daniel**

Retirement Counselor

717-624-5275

[n.daniel@crosskeysvillage.org](mailto:n.daniel@crosskeysvillage.org)



## CROSS KEYS VILLAGE

The Brethren Home Community

2990 Carlisle Pike

New Oxford, PA 17350

[www.crosskeysvillage.org](http://www.crosskeysvillage.org)



*Scan here to learn more about our exciting Hearthside opportunities!*